

- 1
- 2
- 3
- 4
- 5
- 6
- 7
- 8
- 9
- 10
- 11
- 12
- 13
- 14
- 15
- 16
- 17
- 18
- 19

**BODY**

AISI 305 stainless steel.  
Suggested tolerance for plunger housing hole d1 = H7.

**BALL**

AISI 420C hardened stainless steel.

**SPRING**

AISI 631 stainless steel.

**STANDARD EXECUTION**

- **GN 614-NI**: normal end-force spring.
- **GN 614-NIL**: light pressure spring, body with a longitudinal marking.
- **GN 614-NIS**: reinforced pressure spring, body with two longitudinal markings.

**ACCESSORIES**

To optimise the use of GN 614-NI smooth ball spring plungers, have been designed Holders for spring plungers GN 614.1 (see page 625).



Conversion Table	
1 mm = 0.039 inch	
d1	
mm	inch
3	0.12
4	0.16
5	0.20
6	0.23
8	0.31
10	0.39
12	0.47

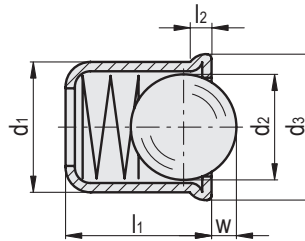

**GN 614-NI**

**INOX** STAINLESS STEEL **METRIC**

Code	Description	d1 +0.1	d2	d3	l1	l2	w	Spring preload [N]	Spring max load [N]	⚖️
GN.31999	GN 614-3-NI	3	2.4	3.5	4	0.75	0.7	1.8	3.5	1
GN.32101	GN 614-4-NI	4	3	4.6	5	0.9	1	2.5	6	2
GN.32111	GN 614-5-NI	5	4	5.6	6	0.9	1.4	3	6.5	3
GN.32121	GN 614-6-NI	6	5	6.5	7	1	1.8	5.5	11.5	4
GN.32131	GN 614-8-NI	8	6.5	8.5	9	1.1	2.4	7	12.5	5
GN.32141	GN 614-10-NI	10	8.5	11	13	1.7	3.3	8.5	18.5	6
GN.32151	GN 614-12-NI	12	10	13	16	2.3	4	12	26.5	7

**GN 614-NIL**

Code	Description	d1 +0.1	d2	d3	l1	l2	w	Spring preload [N]	Spring max load [N]	⚖️
GN.31996	GN 614-3-NIL	3	2.4	3.5	4	0.75	0.7	0.4	1.3	1
GN.32099	GN 614-4-NIL	4	3	4.6	5	0.9	1	0.5	1	2
GN.32108	GN 614-5-NIL	5	4	5.6	6	0.9	1.4	0.5	4.7	3
GN.32118	GN 614-6-NIL	6	5	6.5	7	1	1.8	2.3	6.5	4
GN.32128	GN 614-8-NIL	8	6.5	8.5	9	1.1	2.4	4	9	5
GN.32138	GN 614-10-NIL	10	8.5	11	13	1.7	3.3	3.9	10	6
GN.32148	GN 614-12-NIL	12	10	13	16	2.3	4	6.2	14.6	7

**GN 614-NIS**

Code	Description	d1 +0.1	d2	d3	l1	l2	w	Spring preload [N]	Spring max load [N]	⚖️
GN.31997	GN 614-3-NIS	3	2.4	3.5	4	0.75	0.7	2.4	5.5	1
GN.32100	GN 614-4-NIS	4	3	4.6	5	0.9	1	5	10.4	2
GN.32109	GN 614-5-NIS	5	4	5.6	6	0.9	1.4	6	12	3
GN.32119	GN 614-6-NIS	6	5	6.5	7	1	1.8	7.3	19	4
GN.32129	GN 614-8-NIS	8	6.5	8.5	9	1.1	2.4	11	25	5
GN.32139	GN 614-10-NIS	10	8.5	11	13	1.7	3.3	17	37	6
GN.32149	GN 614-12-NIS	12	10	13	16	2.3	4	28	57	7

Indexing and positioning elements